



# INSTRUCTIONS:

## Royale Converta® 3-in-1 Play-Pen Gate

• Play-Pen • Fireplace Barrier • Wide Barrier Gate

F849  
F2003  
F2161  
ASTM F1004

### IMPORTANT! KEEP FOR FUTURE REFERENCE.

Read INSTRUCTIONS thoroughly before assembling and installing gate.

If you sell or give away this product, make sure you give this Instruction to the new owner.

### ! WARNING

Children have died or been seriously injured when enclosures are not securely installed.

- **ALWAYS** install and use enclosures as directed using all required parts.
- **STOP** using when child can climb over or dislodge/open the enclosure.
- Use only with the locking mechanism securely engaged.
- **NEVER** use an enclosure to keep child away from pool.
- **To prevent falls, NEVER use at top of stairs.**

- The surfaces that the enclosure is to be fixed to must be suitable for purpose and structurally sound.
- Intended for use with children from 6 months through 24 months.
- This enclosure has a manual close system.
- This product will not necessarily prevent all accidents. **NEVER** leave child unattended.
- Do not use Play-Pen at the top of stairs.
- The Play-Pen is not intended for sleep use.
- Do not place the Play-Pen close to an open fire or other heat source.
- If using this enclosure as a fireplace barrier, ensure it is installed at least **60cm / 23.5in** from fire source.
- This enclosure is intended for indoor use and is not to be exposed to outdoor elements.
- Barrier can be used to create a landing area at the top or base of stairs. Never use at top of stairs directly across top step.
- Discontinue use if gate becomes damaged, broken, or disassembled.
- Do not leave anything in the Play-Pen which may provide a foothold for climbing
- The safety barrier must not be fitted across windows.
- This barrier is for domestic use only.

Fits Opening 3.8m / 151in

## COMPONENTS

- A** Gate Panel
- B** Barrier Panel
- C** Upper Securing Hinge
- D** Securing Screw
- E** Lower Hinge
- F** Vertical Bar
- G** Vertical Bar Top Casing
- H** Gate Release Switch
- I** Gate Upper Lock
- J** Gate Lower Lock

### Wall Mounting Parts

- K** Upper Mount ( Side X)
- L** Upper Mount ( Side Y )
- M** Lower Mounts
- N** Wood Screws (38mm / 1.5in)
- O** Lower Hinge Cap (Installed)
- P** Floor Cap

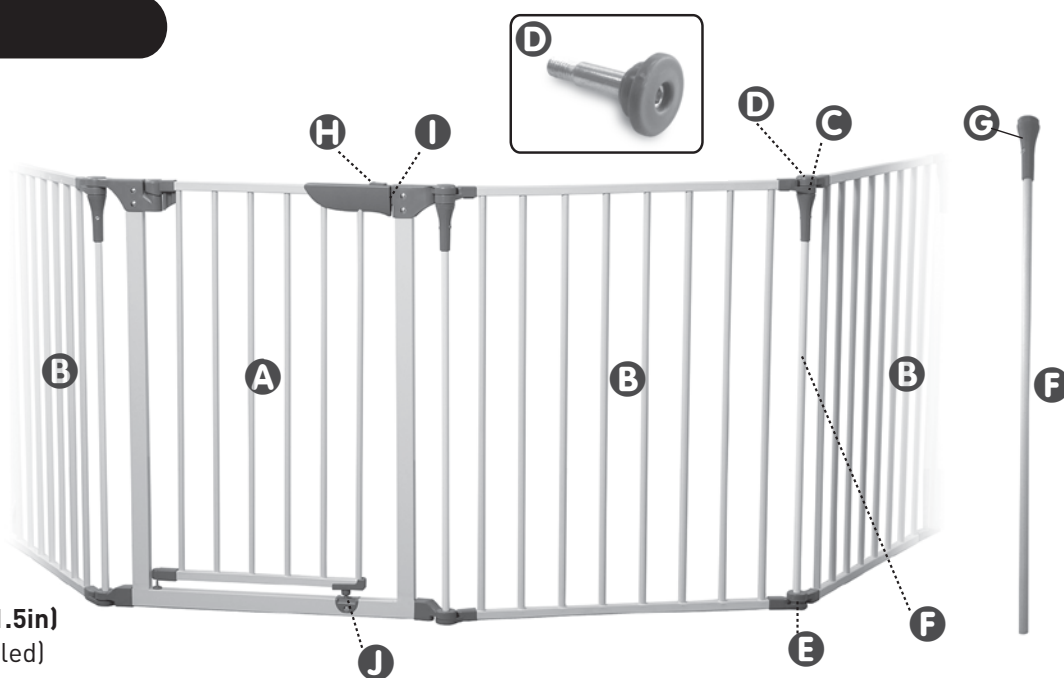

### Required for Assembly/mounting

- Q** Allen Key (4mm)



**WARNING** This package contains small parts and sharp points in an unassembled state. Keep out of reach of children. Adult assembly required.

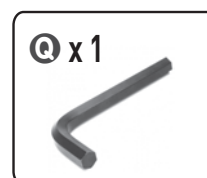
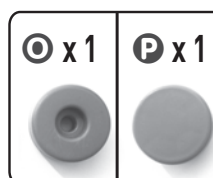
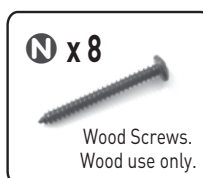
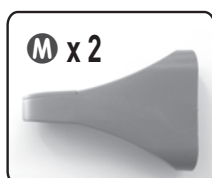
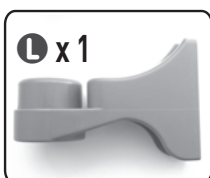
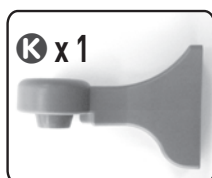

For Brick or Masonry use the appropriate fittings, screws and plugs for your wall (not included).

**NOTE:**  
Store Allen Key safely out of reach of children. Keep for future use.

# PLAY-PEN ASSEMBLY

**1** Remove Play-Yard from packaging and place upright on flat surface.

**2** Position panels to desired shape.

**3** The vertical bars **F** at each end of the Play-Yard must first be removed.

**Note-** For Play-Yard assembly only one of these vertical bars are required.

The other vertical bar is only used when wall mounting as a barrier gate or fire barrier, store for future use. For shipping purposes one of these vertical bars is temporarily secured at the lower hinge **E** with a securing screw **D**.

- Use Allen Key **A** to remove securing screw **D** from upper securing hinge **C**, and lower hinge **E**. Keep screws for future use. Keep out of reach of children.
- Release the vertical bars **F** from the upper securing hinge **C** by pulling down on the top casing **G**.
- Twist to release and remove vertical bar **F** from lower hinge **E**.

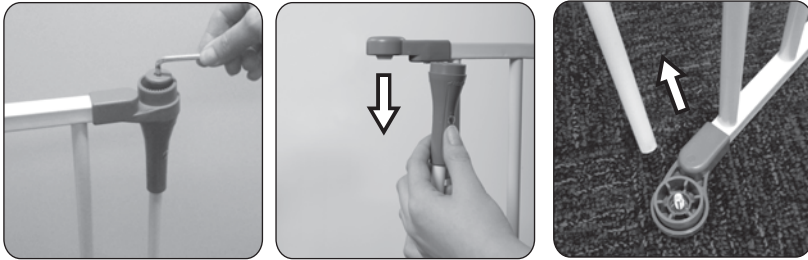

**4** Join panels by connecting upper securing hinge **C** and lower hinge **E**.



**5** Install vertical bar **F**.

- Insert vertical bar into lower hinge **E**. Twist to lock into place.
- Pull down top casing **G** and insert into upper securing hinge **C**.
- Insert securing screw **D** and position in place with Allen Key **A**.



**6** Position Play-Pen into desired shape, then lock and secure by firmly tightening all securing screws **D** using Allen Key **A**.



**A** x 1

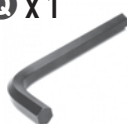

**Assembled  
Play-Pen**



**Play-Mats available  
(sold separately)**  
F962/F2006/F2163



**Gate Extensions  
(sold separately)**  
F1950/F2005/F2166  
**Note-** minimum of 2  
panels can be added.

# BARRIER GATE OR FIREPLACE BARRIER INSTALLATION



Ensure the surface you mounting the barrier is structurally sound such as solid timber, brick or masonry. DO NOT install to hollow walls. For plaster/gyprock surface, locate the timber beam or stud behind and mount in this location (mounting on plaster/gyprock alone is not strong enough and not safe). **DO NOT MOUNT TO GLASS.**

- 1 Follow steps 1-3 of Play-Pen assembly.
- 2 Locate best position for barrier gate/fireplace barrier to be installed. Position panels to desired shape placing end panels close to the wall.
- 3 Cut out templates and position on wall.  
**Note-** The 2 ends of the barrier gate/fireplace barrier are different. Match the template to correct end.
- 4 Mark screw holes.
- 5 Drill holes.
- 6 Install wall mounts Side **X** and Side **Y**.

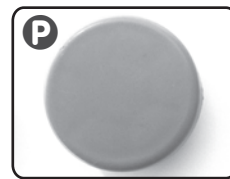
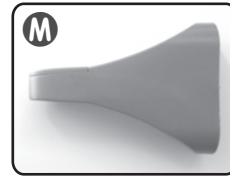
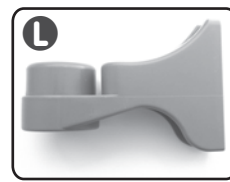
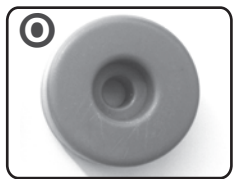
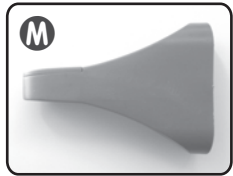
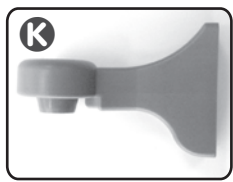
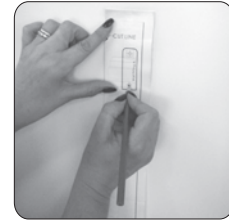

**SIDE X**

- Insert upper mount **K** and lower hinge cap **O**.
- Thread lower mount **M** onto vertical bar **F**.
- Install vertical bar **F** into lower hinge cap **O** and upper mount **K**.
- Insert securing screw **D** and position in place with Allen Key **Q**.

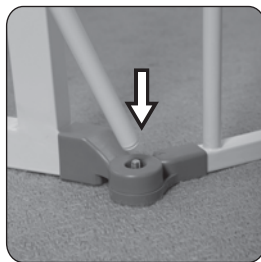

**SIDE Y**

- Thread lower mount **M** onto vertical bar **F**.
- Install floor cap **P** under lower hinge **E**.
- Insert upper mount **L** onto upper securing hinge **C** and hold in place.
- Insert vertical bar **F** into lower hinge **E** and upper mount **L**.
- Insert securing screw **D** and position in place with Allen Key **Q**.





- 7 Align both sides with template and affix with screws **N**.

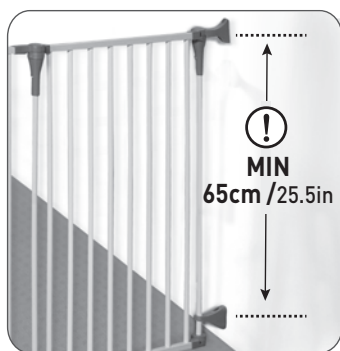

**N** x 8



Wood screws **N** included.



For Brick or Masonry use the appropriate fittings, screws and plugs for your wall (not included)

- 8 Position barrier gate/fireplace barrier into desired shape, then lock and secure by firmly tightening all securing screws **D** using Allen Key **Q**.



**Q** x 1



To reduce movement across a wide span, form a ZIG-ZAG shape with the panels.

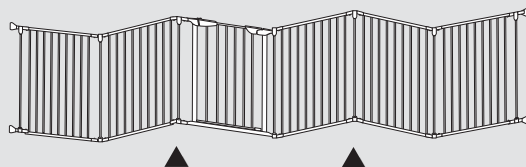

## FIREPLACE BARRIER

• FIREPLACE

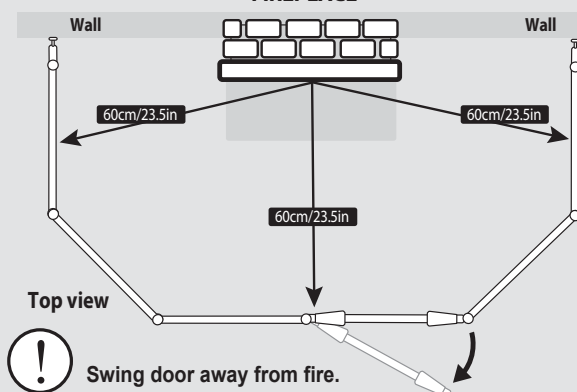

**Caution:**  
If using this enclosure as a fireplace barrier, ensure it is installed at least 60cm/23.5in from fire source.



Assembled Fireplace Barrier

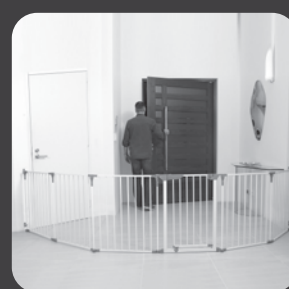

Assembled Barrier Gate

## GATE OPERATION

Slide the release switch **H** and lift gate panel **A**.

Gate swings in both directions.

Swing gate closed ensuring upper **I** and lower **J** locks engaged.

Swing gate fully open to engage **SMART STAY OPEN** feature.

**Caution: This safety gate has a manual close system.**

**Keep gate closed when children are present.**

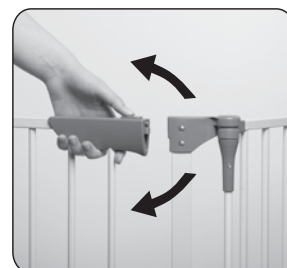
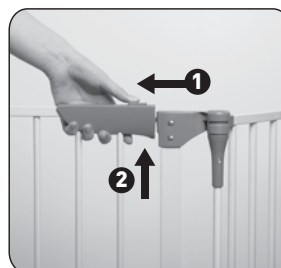

## MAINTENANCE & CARE

- Play-Pen/Fireplace Barrier/Barrier Gate must be fitted according to instructions to ensure it works correctly.
- Regularly check all parts to ensure Play-Pen/Fireplace Barrier/Wide Barrier Gate is secure. Adjust as required.
- To clean, wipe surface with a damp cloth using mild detergent and warm water.  
Never clean with abrasive, ammonia, bleach or spirit based type cleaner.
- Only use Dreambaby® spare parts. Any additional and replacement parts should be obtained from Tee-Zed Products.

**Look for the Dreambaby® range of Child Safety and Care Products.**

Tee-Zed acknowledges that its customers may be entitled to statutory consumer guarantees and does not seek to exclude or limit them. These guarantees include that Tee-Zed's products are of acceptable quality. This Tee-Zed product is for the specific purpose detailed in the instructions and packaging and Tee-Zed considers use outside of that purpose to be abnormal use. To the maximum extent permitted by law, Tee-Zed does not accept any liability for damage:

- arising from abnormal use of the products;
- caused by installation or removal of the products other than in accordance with the supplied installation and removal instructions; or
- arising under the law of tort or contract.

Dreambaby® products by **Tee-Zed**

Tee-Zed Products Pty Ltd  
PO Box 2022,  
Bondi Junction NSW 1355  
Australia

+61 (0)2 9386 4000  
info@tee-zed.com.au  
www.dreambaby.com.au

Tee-Zed Products (N.Z.) Ltd  
PO Box 64013,  
Botany Town Centre Auckland  
New Zealand

+64 (0)9 274 8788  
info@tee-zed.co.nz  
www.dreambaby.co.nz

Tee-Zed Products Ltd  
PO Box 29227,  
Dunfermline, KY12 2DN  
United Kingdom

+44 (0)844 800 9445  
info@tee-zed.co.uk  
www.dreambaby.co.uk



Made in Hangzhou, China.

©2020 Tee-Zed Products Pty Ltd



dreambabysafety

YouTube

dreambabytv